

# TECHNICAL DATA

## Portals Quiet

Spacestor®

### Product Overview

Portals Quiet is a flexible collection of individual working spaces, a quiet oasis for privacy and focus work, whilst still retaining a sense of connection to the rest of the workspace. Recognizing the need for adaptability, Portals Quiet has future flexibility designed in from the start so it can be reconfigured as the office adapts to future needs. With 8 interchangeable sizes available, it meets the needs of many users and tasks through a variety of spaces, from small touchdown perches to accessible height-adjustable desk options.

### Dimensions

#### Built-in Seat 52½" w x 42"/53¾" d x 88" h

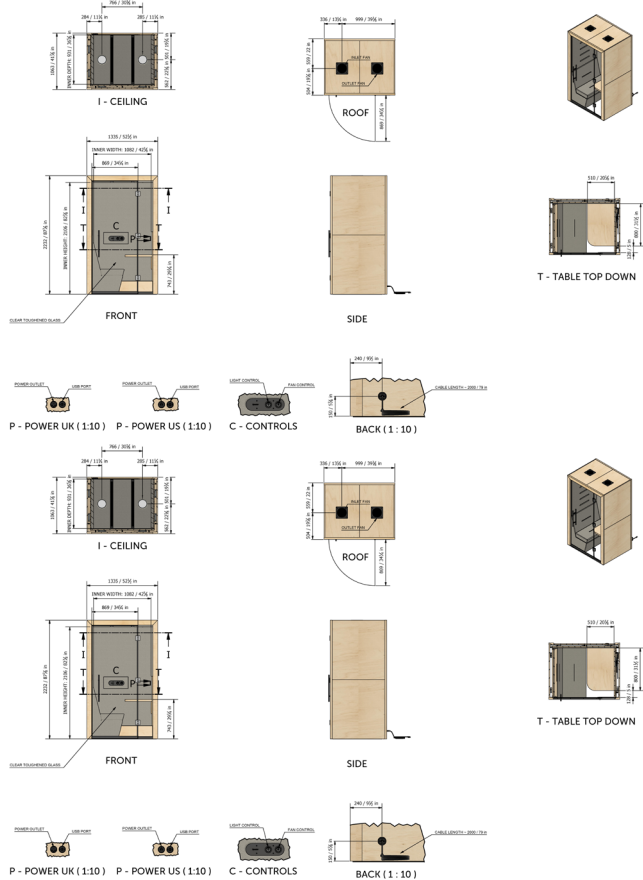

#### BYO Chair 52½" w x 42"/53¾" d x 88" h

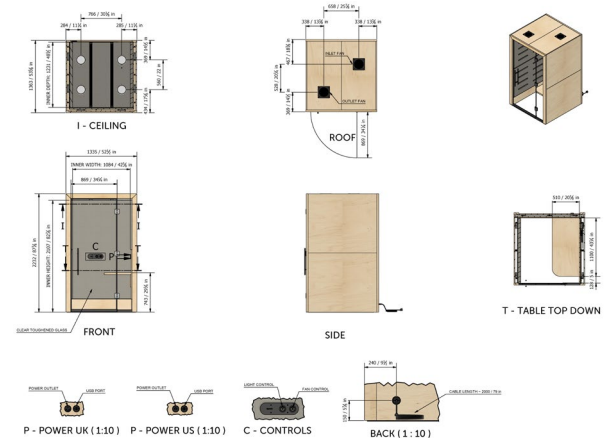
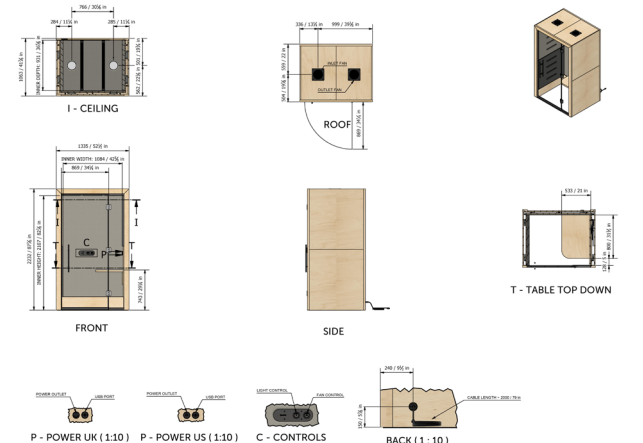

#### Standing 52½" w x 42"/53¾" d x 88" h

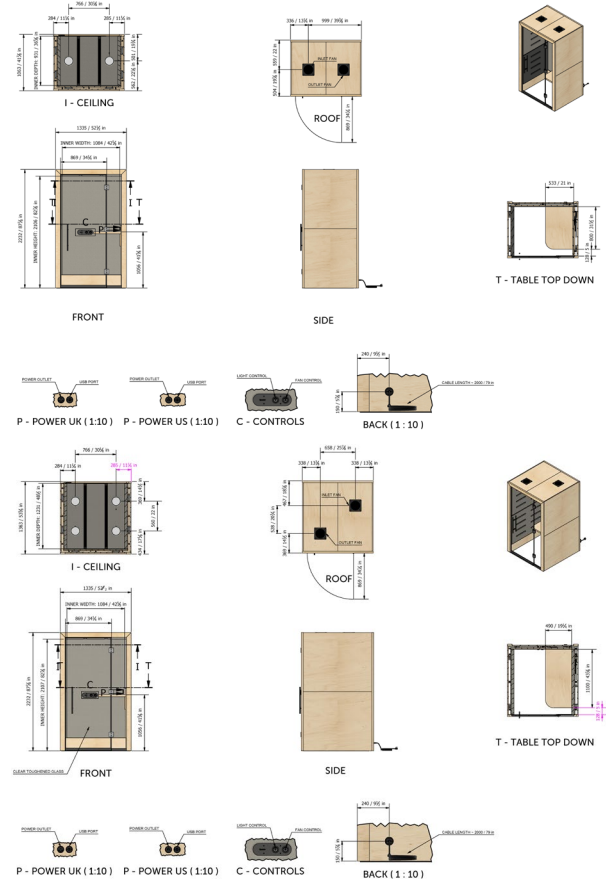

#### Adjustable Desk 52½" w x 42"/53¾" d x 88" h

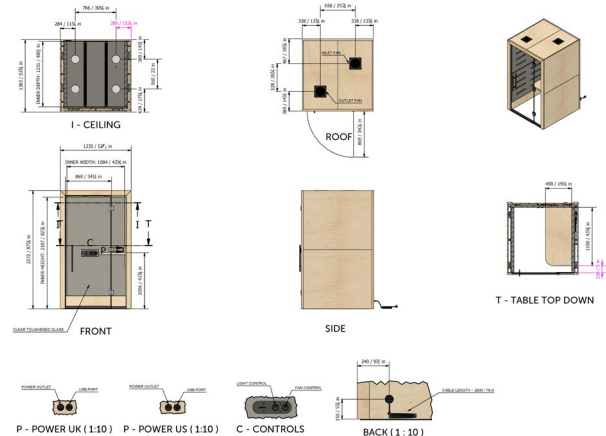

## Portals Quiet

### Environmental Summary

During the development journey we always kept our environmental impact in mind. This is demonstrated in the following key features of the design when the pod is purchased with the recommended finishes:

- All materials used are LBC 3.1 Red List Compliant, an extremely stringent standard
- Patented PVC-free acoustic door seal
- Product lifecycle – the products are designed to be modular and reconfigurable to cater for future needs without wastage and using more resources.
- Power usage – the products are designed with minimum idle power usage, with a PIR movement sensor to switch off the lighting after a period of non-use.
- FSC certified lumber.

### Environmental Document & Declare Label



### Sustainability Compliance

Spacestor products support leading sustainability standards including WELL, LEED, BREEAM, LBC (Living Building Challenge), and SKA. By aligning with these frameworks, we help you create environmentally responsible spaces that enhance employee wellbeing.

We simplify the complexity of certification by providing clear, tailored guidance and product-specific compliance breakdowns for your project.

Scan above for more information or contact your dedicated rep for detailed documentation.

### Electrics

#### Lighting & Power

LED Spotlights for consistent illumination is supplied on a PIR system with movement sensor. Quantity changes by variation.

1 x Regional Power, 1 x Twin USB (USB-A and USB-C)

#### Electrical Diagram

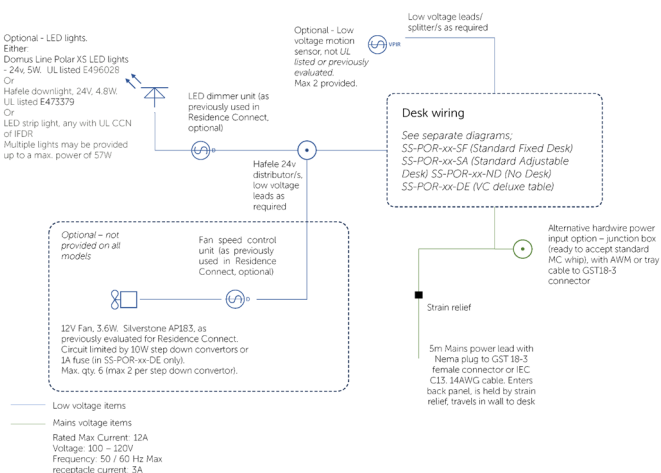

### Ventilation

User Adjustable Ventilation. Ceiling mounted fan ventilates unit with ambient building air

- Airflow; 25 - 140cfm
- Speed; 400 - 1500rpm
- Static pressure; 0.25 - 3mm H2O



### Safety

#### Ergonomics

Our Portals Quiet range features options of different ergonomic seating positions, including built-in seats, or the option to bring your own ergonomic task chair, allowing users to maintain optimal posture and reduce strain.

#### Fire Ratings

- Upholstery fabric selected from approved contract quality fabric ranges, minimum Matindale test of 45,000 rubs and tested to Crib 5 or C&M
- Fabric & foam supplied complies with BS 7176: Firest test to non-domestic seating – Standard Brief.
- BS 7176 specified requirements for the resistance to ignition of upholstered furniture used for seating when tested in accordance with BS 5852, BS EN 1021-1 or BS EN 1021-2, as appropriate. The levels of ignition resistance have been set after careful consideration of the fire risk of the particular end-use environment involved.

#### Sprinklers

To address the need for any required fire sprinkler regulations, this product can accept a sprinkler head drop from the building fire sprinkler system via a cut out, managed per project with the Project Manager. A flexible fire sprinkler drop is recommended.

#### Lifting

Product must be handled by 2 operatives.

#### General safety

- All maintenance and repair tasks must be performed by appropriately qualified and authorised technicians.
- Only use tools that are appropriate for these tasks.
- For longer periods of absence or if there is a thunderstorm, unplug the power supply cable from the power outlet to avoid damage due to grid-related over-voltage.

#### Structural

Adjustable levellers on the product have up to 13/16" / 20mm tolerance.

#### Seismic

To address the need for any required seismic regulations, this product can be fitted with brackets, managed per project with the Project Manager.

### Acoustics

#### Rating

The acoustic performance was optimised during the design process to achieve speech intelligibility privacy by using high acoustic performance materials.

'Acoustic performance' of a pod is the noise reduction level (sound from inside to outside/outside to inside). Noise reduction level is affected by external factors - e.g. the environment, external noise level, how close the pod is to a wall etc.

The materials used in the products have noise absorbing properties ranging from 30 to 60+ db rating but this is not representative of the product as a whole.

We have designed our products in such a way to block sound transfer but there are other factors such as the building sub-floor etc. that affect the noise reduction level.

Laboratory Measurements of the Speech Level Reduction:

AIRO Testing No.	Test Specimen	D <sub>SA</sub> (dB)	Class
L/3588/A	Portals Quiet	22.7	C

Rating according to International Standard ISO 23351-1:2020

Laboratory Measurements of the Noise Isolation Class:

AIRO Testing No.	Test Specimen	NIC (dB)
L/3588/C	Portals Quiet	25

Rating according to American Standard ASTM E413-16

These measurements were made on 23 November 2023, since then several changes have been made, enhancing the acoustic performance of our pods including extensive in-house testing. Some of the improvements include:

- Added acoustic absorption material in roof and wall voids, maintaining airflow.
- Silicone base seal to the product base, patented design seals gap between wall and floor.
- Increased thickness of glass front and door.
- Improved flipper seal around door for better gap-free seal.
- Added drop-down seal to bottom of door with metal threshold for tight seal.

Added bubble seal to clad panel joints.

Shipping

Shipping dims/weight/packaging are dependant per project - please enquire.